



Application B338079

WESTERN

AUSTRALIA

Volume 1102 Folio 776

1467 058



CERTIFICATE OF TITLE

UNDER THE "TRANSFER OF LAND ACT, 1893" AS AMENDED

I certify that the person described in the First Schedule hereto is the registered proprietor of the undermentioned estate in the undermentioned land subject to the easements and encumbrances shown in the Second Schedule hereto.

DATED 17th May, 1977

Lumbrough
REGISTRAR OF TITLES



ESTATE AND LAND REFERRED TO

Estate in fee simple in portion of Parkerville Lot 45 and being Lot 59 on Plan 11970, delineated and coloured green on the map in the Third Schedule hereto, limited however to the natural surface and therefrom to a depth of 60.96 metres.

FIRST SCHEDULE (continued overleaf)

~~The Perth Diocesan Trustees of Law Chambers, Cathedral Square, Perth.~~

SECOND SCHEDULE (continued overleaf)

NIL

Lumbrough

REGISTRAR OF TITLES

THIRD SCHEDULE

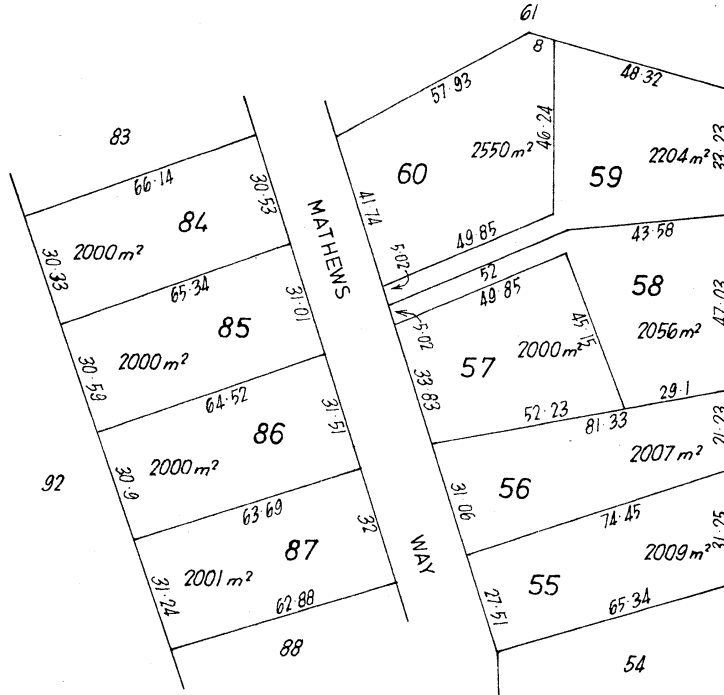

A 9320
P. 46

Scale 1:1500
17/5/77

PERSONS ARE CAUTIONED AGAINST ALTERING OR ADDING TO THIS CERTIFICATE OR ANY NOTIFICATION HEREON

NOTE: RULING THROUGH AND SEALING WITH THE OFFICE SEAL INDICATES THAT AN ENTRY NO LONGER HAS EFFECT. ENTRIES NOT RULED THROUGH MAY BE AFFECTED BY SUBSEQUENT ENDORSEMENTS.

53083/12/75-20M-S/2860

Superseded - Copy for Sketch Only

Page 1 (of 2 pages) 1467 VOL. 058 FOL.

FIRST SCHEDULE (continued) NOTE: RULING THROUGH AND SEALING WITH THE OFFICE SEAL INDICATES THAT AN ENTRY NO LONGER HAS EFFECT. ENTRIES NOT RULED THROUGH MAY BE AFFECTED BY SUBSEQUENT ENDORSEMENTS.

REGISTERED PROPRIETOR	INSTRUMENT		REGISTERED	TIME	SEAL	INITIALS
	NATURE	NUMBER				
Gregory Richard <u>Rusha</u> , Student, and <u>Elizabeth Patricia Rusha</u> , Housewife, both of 5A <u>Trevithick Close</u> , <u>Stirling</u> , as joint tenants. <u>Darryl Bruce Lang</u> and <u>Kaylene Margaret Hall</u> both of 18 <u>Mathews Way</u> , <u>Stoneville</u> , as <u>joint tenants</u> . <u>Renate Elisabeth Stewart</u> of 18 <u>Mathews Way</u> , <u>Stoneville</u> . <u>Terence Edward Hoy</u> and <u>Lorraine Wendy Hoy</u> both of 18 <u>Mathews Way</u> , <u>Stoneville</u> , as <u>joint tenants</u> . <u>John Leslie Webb</u> of 18 <u>Mathews Way</u> , <u>Stoneville</u> .	Transfer	C720543	1.3.84	9.56		
	Transfer	F984646	19.9.95	9.23		
	Transfer	G638967	18.11.97	11.54		
	Transfer	H78546	13.4.99	9.05		
	Transfer	H368321	21.2.00	16.03		

SECOND SCHEDULE (continued) NOTE: RULING THROUGH AND SEALING WITH THE OFFICE SEAL INDICATES THAT AN ENTRY NO LONGER HAS EFFECT. ENTRIES NOT RULED THROUGH MAY BE AFFECTED BY SUBSEQUENT ENDORSEMENTS.

PARTICULARS	INSTRUMENT		REGISTERED	TIME	SEAL	INITIALS	CANCELLATION	NUMBER	REGISTERED OR LODGED	SEAL	INITIALS
	NATURE	NUMBER									
to <u>Perth Building Society</u> . to <u>Adelaide Bank Ltd</u> . to <u>Commonwealth Bank of Australia</u> . to <u>National Australia Bank Ltd</u> .	Mortgage	C761186	2.5.84	12.09				F984645	19.9.95		
	Mortgage	F984647	19.9.95	9.23				G638966	18.11.97		
	Mortgage	H103087	10.5.99	8.58				H368320	21.2.00		
	Mortgage	H368323	21.2.00	16.03							